

5.1 Holdingham

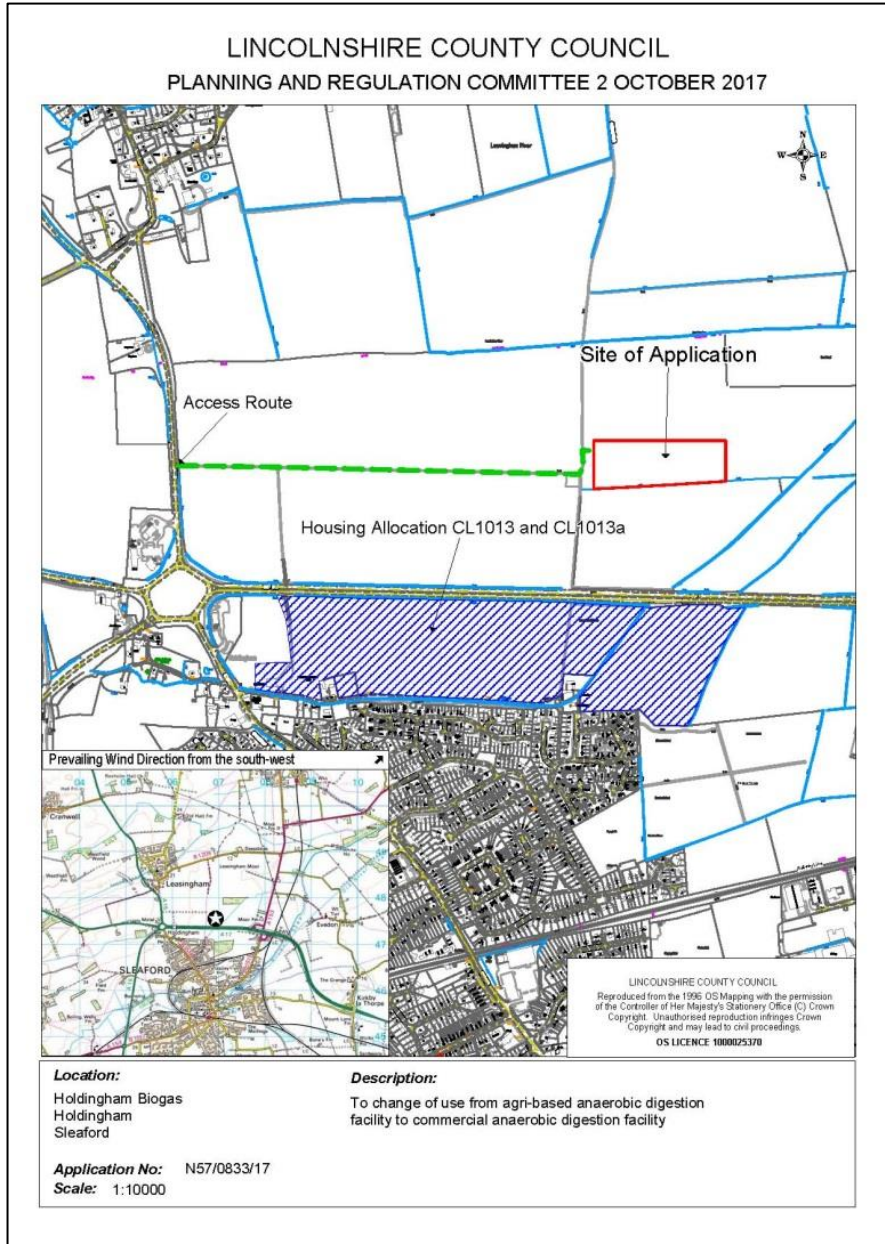

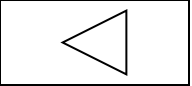

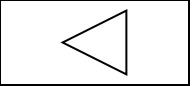



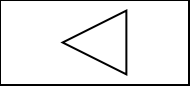

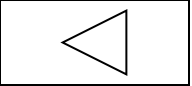

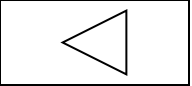

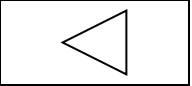

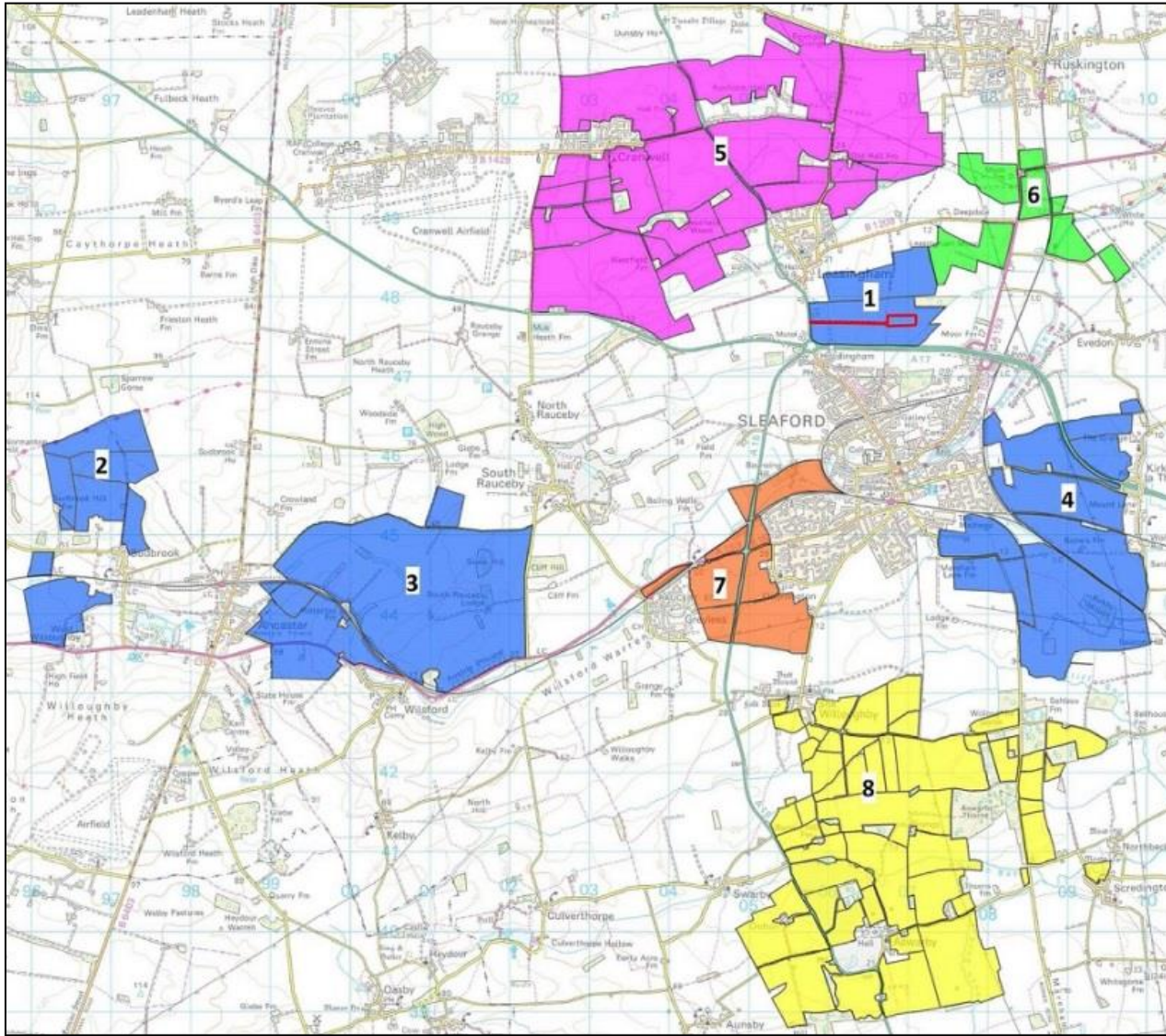

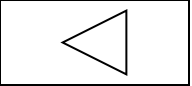

6.1 Lincoln

LINCOLNSHIRE COUNTY COUNCIL
PLANNING AND REGULATION COMMITTEE 2 OCTOBER 2017

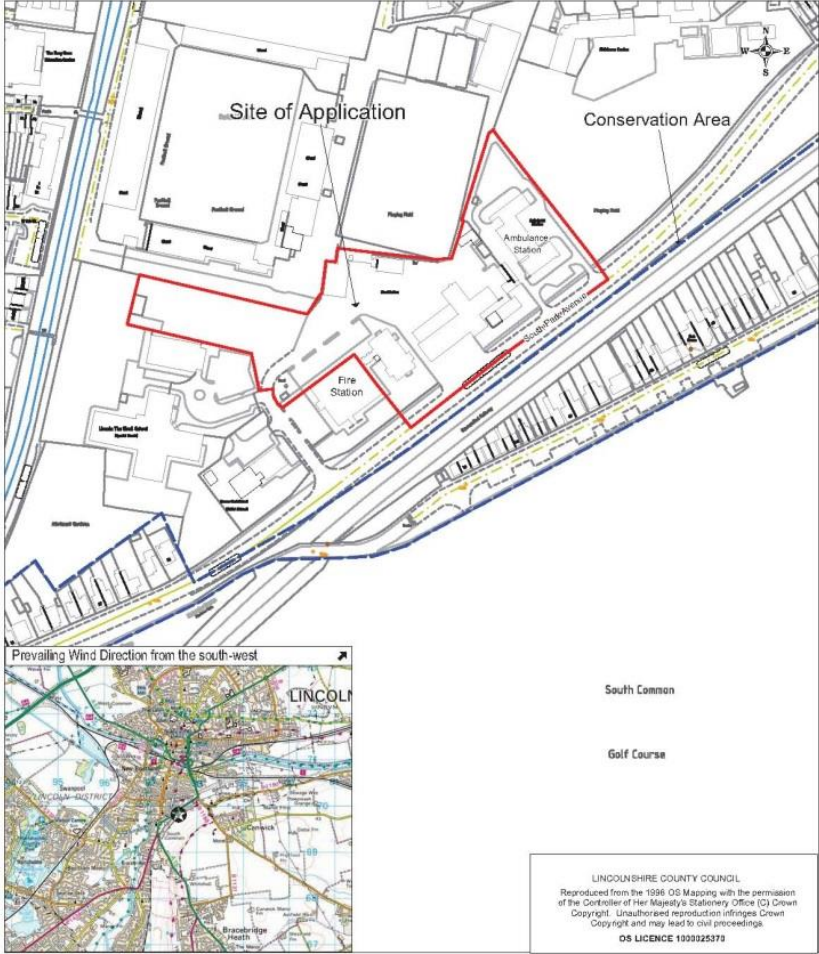

LINCOLNSHIRE COUNTY COUNCIL
 Reproduced from the 1098 OZ Mapping with the permission
 of the Controller of Her Majesty's Stationery Office (C) Crown
 Copyright. Unauthorised reproduction infringes Crown
 Copyright and may lead to civil proceedings.
 OS LICENCE 100025370

Location:
 Lincoln HQ Fire Station
 South Park Avenue
 Lincoln

Description:
 For the demolition of existing buildings and redevelopment
 of the site to create a Blue Light Campus comprising of
 combined offices and facilities for Lincolnshire Fire & Rescue,
 Lincolnshire Police and the East Midlands Ambulance Service

Application No: L/0832/17
Scale: 1:2500

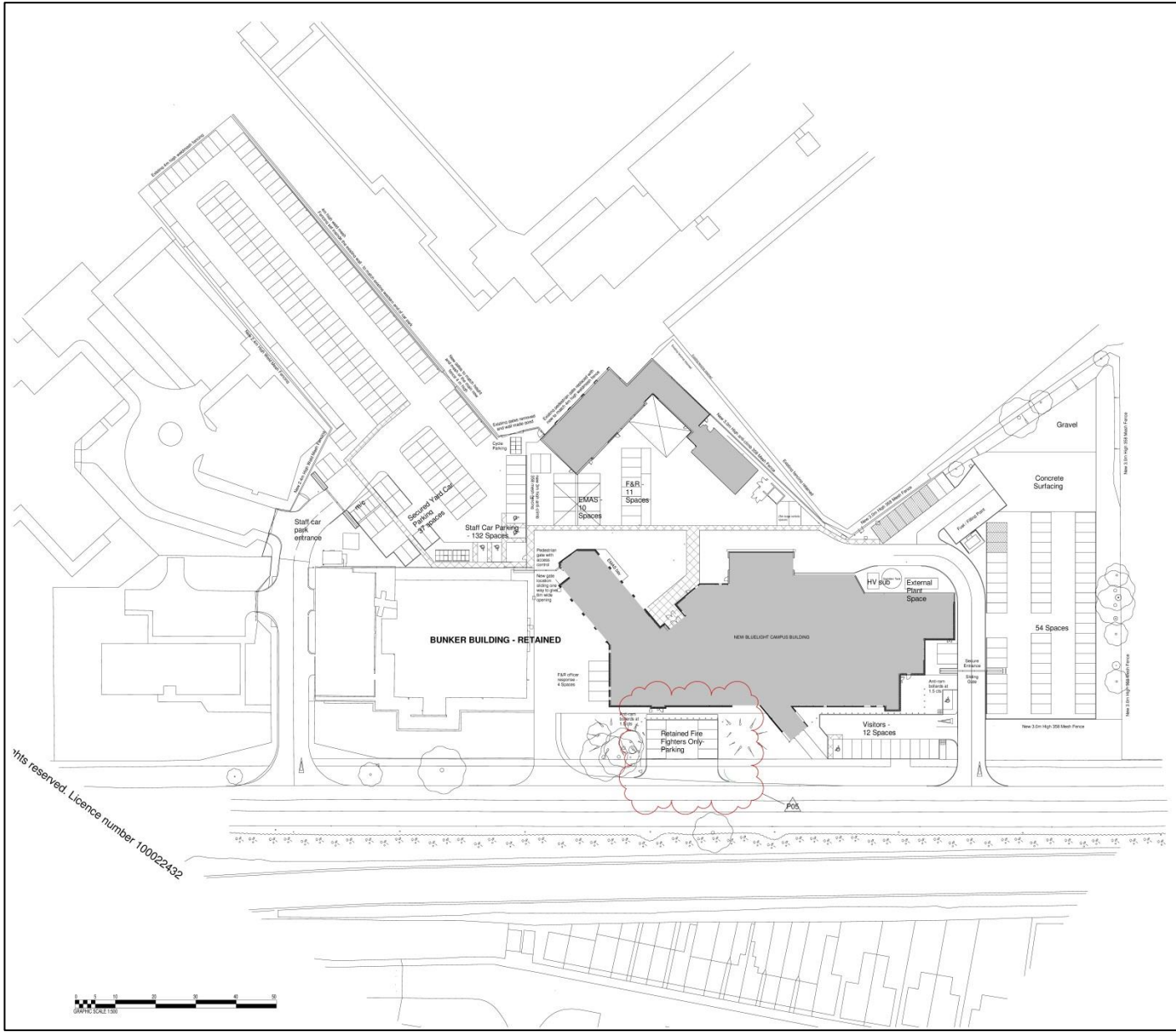

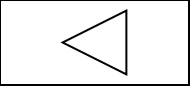

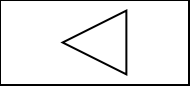

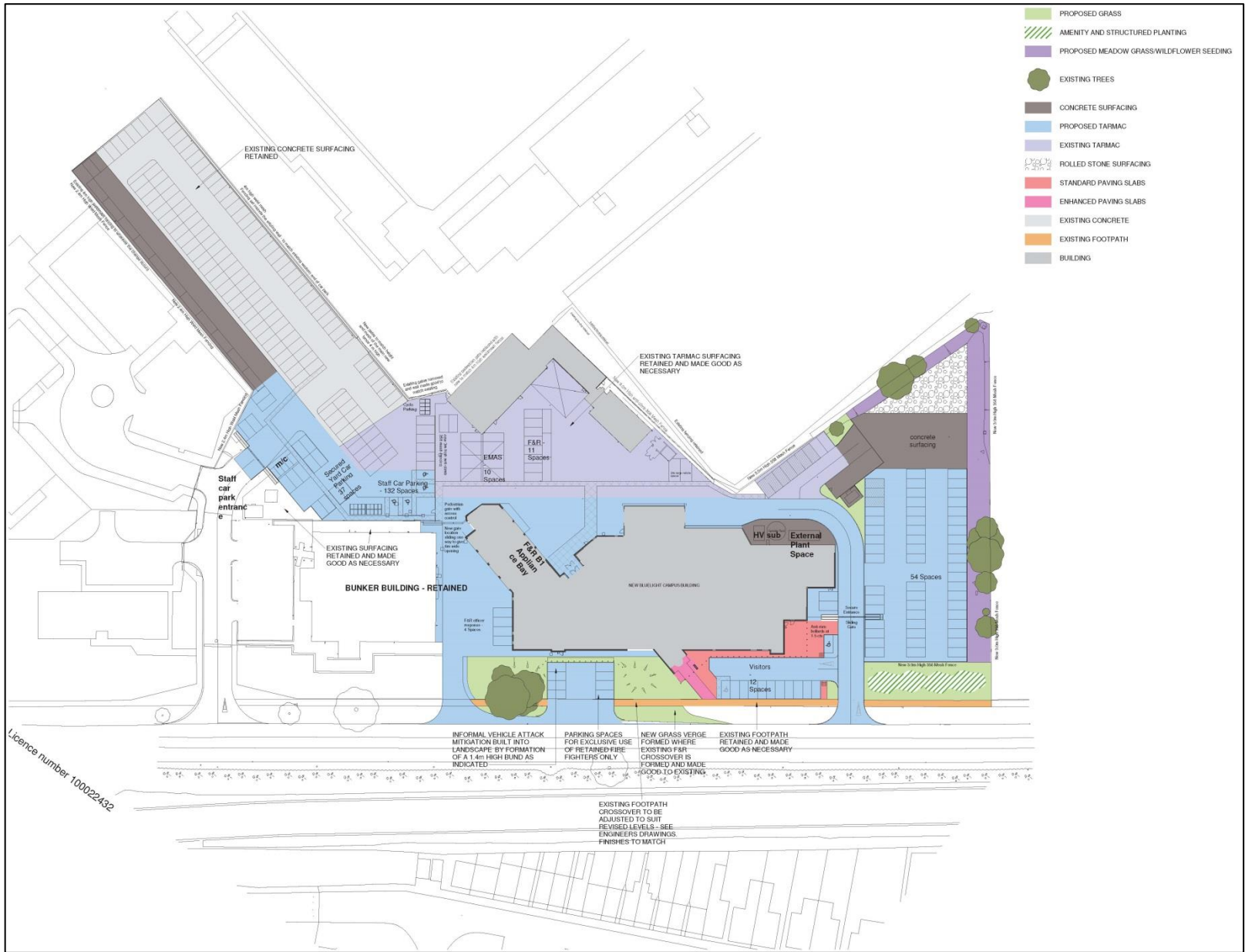

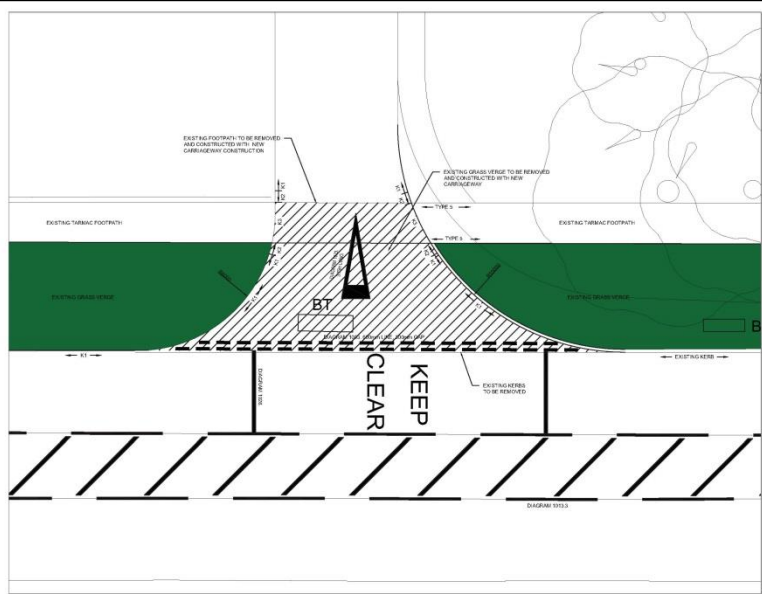

WEST JUNCTION ARRANGEMENT
1150

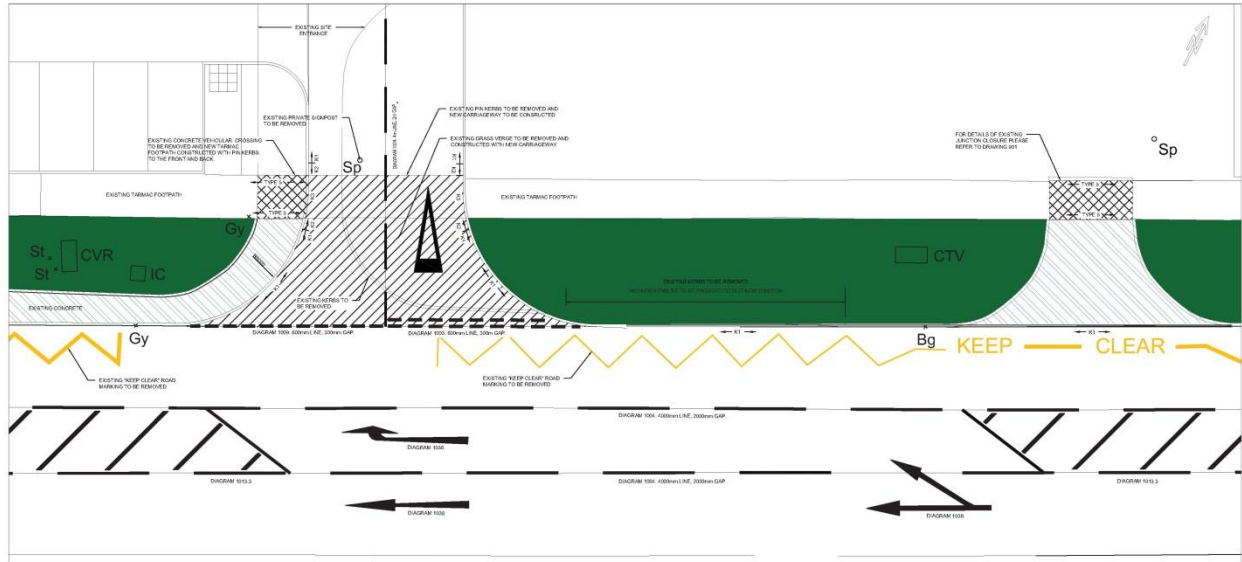

EAST JUNCTION ARRANGEMENT
1151

MATERIAL SPECIFICATIONS						
NO.	DESCRIPTION	QUANTITY	UNIT	REMARKS	REMARKS	
1	CONCRETE	10000	M ³	10000	10000	10000
2	ASPHALT	10000	M ²	10000	10000	10000
3	GRAVEL	10000	M ³	10000	10000	10000
4	BRICKS	10000	NO.	10000	10000	10000
5	ROOFING	10000	M ²	10000	10000	10000
6	PAINT	10000	LITRES	10000	10000	10000

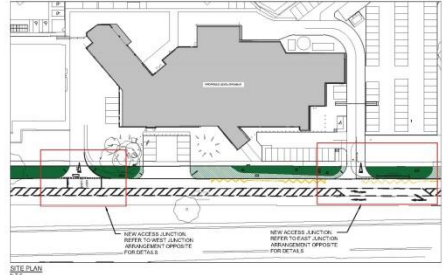

SITE PLAN



TYPE B1 TYPE B2 BARRIER
AND TYPE B3 BARRIER
WITHOUT BARRIER

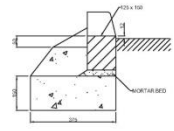

TYPE BT TYPE B BOLLARD
WITH BOLLARD

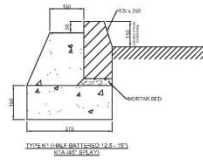

TYPE Bg TYPE B BOLLARD
WITH BOLLARD

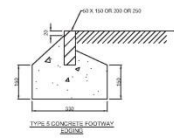

TYPE Gy TYPE B BOLLARD
WITH BOLLARD

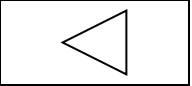

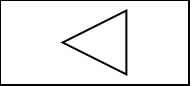

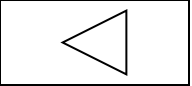

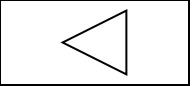

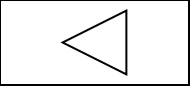

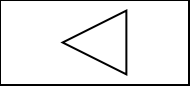

27/09/2017

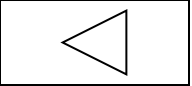

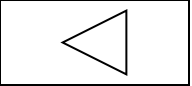

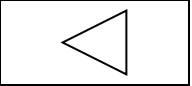

27/09/2017

